

CP550EPFCLCD/CP900EPFCLCD
CP900EIPFCLCD

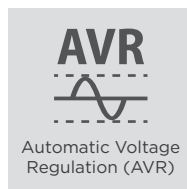

ELEGANT AND RELIABLE PFC UPS

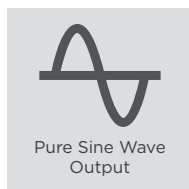
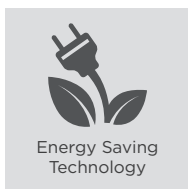
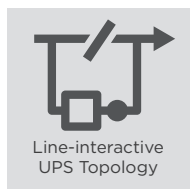

The Pure Sine Wave UPS for equipment requiring active PFC power source

Designed for home, office and back office applications, the PFC Sinewave Series adopts line-interactive topology with Automatic Voltage Regulation (AVR) function to offer stabilized Pure Sine Wave output. The products are compatible with equipment requiring active PFC power supply. Other features include RJ11/RJ45 port to provide data line protection against surge and spike, and power management software to perform PC graceful shutdown.

SERIES FEATURES

- Line-interactive UPS Topology
- Energy Saving Technology
- Active PFC Compatible
- Pure Sine Wave Output
- Automatic Voltage Regulation (AVR)
- LCD Status Display
- LED Status Indicator
- PowerPanel Management Software
- Surge and Spike Protection
- Phone/Fax/Modem/DSL/Network Protection
- Tower Form Factor

PRODUCT CALLOUTS

- 1 . Power On Indicator
- 2 . Power On/Off Switch
- 3 . LCD Display Panel
- 4 . Function Button(s)
- 5 . Communication Protection Ports RJ11/RJ45
- 6 . Input Circuit Breaker
- 7 . USB Port
- 8 . Battery Backup & Surge Protected Outlets
- 9 . AC Inlet

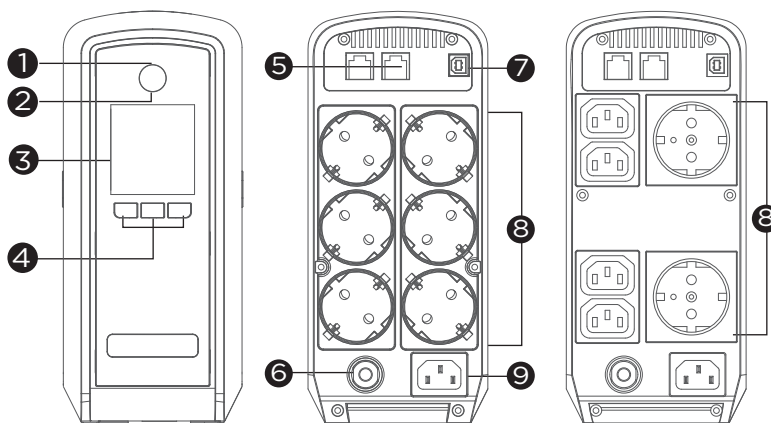

CP550/900E(I)PFCLCD

CP550/900EPFCLCD

CP900EIPFCLCD



TECHNICAL SPECIFICATIONS

Model Name	CP550EPFCLCD		CP900EPFCLCD	CP900EIPFCLCD
General				
UPS Topology	Line-interactive			
Energy Saving Technology	GreenPower UPS™ Bypass Technology			
Active PFC Compatibility	Yes			
Input				
Nominal Input Voltage (Vac)	220, 230, 240			
Input Voltage Range (Vac)	170 - 270			
Input Frequency Detection	Auto-sensing			
Rated Input Current (A)	10			
Input Connector Type	IEC C14			
Output				
Capacity (VA)	550	900		
Capacity (Watts)	350	540		
On Battery Waveform	Pure Sine Wave			
On Battery Voltage(s) (Vac)	230 ± 10%			
On Battery Frequency (Hz)	50 ± 1%, 60 ± 1%			
Automatic Voltage Regulation (AVR)	Single Boost			
Overload Protection	Internal Current Limiting, Circuit Breaker			
Outlet(s) - Total	6			
Outlet Type	Schuko x 6		Schuko x 2, IEC C13 x 4	
Outlet(s) - Battery & Surge Protected	6			
Typical Transfer Time (ms)	4			
Battery				
Runtime at Half Load (min)	10.5	7		
Runtime at Full Load (min)	3.5	1		
Typical Recharge Time (Hours)	8			
User-replaceable	Yes			
Battery Type	Sealed Lead-acid			
Replacement Battery Pack (RBP)	RBP0139	RBP0007		
Replacement Battery Pack (RBP) Quantity (pcs)	1			
Surge Protection & Filtering				
Surge Suppression (Joules)	405			
EMI/RFI Filtration	Yes			
Phone/Network Protection RJ11/RJ45 (Combo)	1-in, 1-out			
Management & Communications				
LCD Panel	Yes			
LED Indicators	Power On			
HID Compliant USB Port(s)	1			
Audible Alarms	Battery Mode, Low Battery, Overload, UPS Fault			
Power Management Software	PowerPanel Personal (Recommended)			
Physical				
Form Factor	Tower			
Physical Size - UPS Module				
Dimensions (WxHxD) (mm.)	100 x 230 x 275			
Weight (kg.)	6.6	7.1	6.67	
Environmental				
Operating Temperature (°C)	0 - 40			
Operating Relative Humidity (Non-condensing) (%)	0 - 95			
Online Thermal Dissipation (BTU/hr)	31			
Certifications				
Certifications*	CE, EAC, RCM		CE	
RoHS	Yes			

*Certifications may vary according to different regions. Visit www.cyberpower.com for more information.
#All specifications are subject to change without notice.

