

ALL-SWD530x Serie

ALLNET 19" Wandgehäuse offen

Wandgehäuse von 4-9 Höheneinheiten

Grundausrüstung: Stahlblechgehäuse, offen, zerlegt, Käfigmuttern mit Schrauben

Farbe: Lichtgrau ähnlich RAL7035

Besonderheiten: 19" Lochrasterprofile an der vorderen 19" Ebene (nicht verstellbar)

Belastbar: Bis max. 40Kg

Nutztiefe: ca. 280mm

Artikel	Außenmasse (B/T/H)	Nutzhöhe	Farbe	Herstellernummer
137505	500/300/276mm	4HE	Lichtgrau	ALL-SWD5304Grau
137506	500/300/365mm	6HE	Lichtgrau	ALL-SWD5306Grau
137507	500/300/499mm	9HE	Lichtgrau	ALL-SWD5309Grau

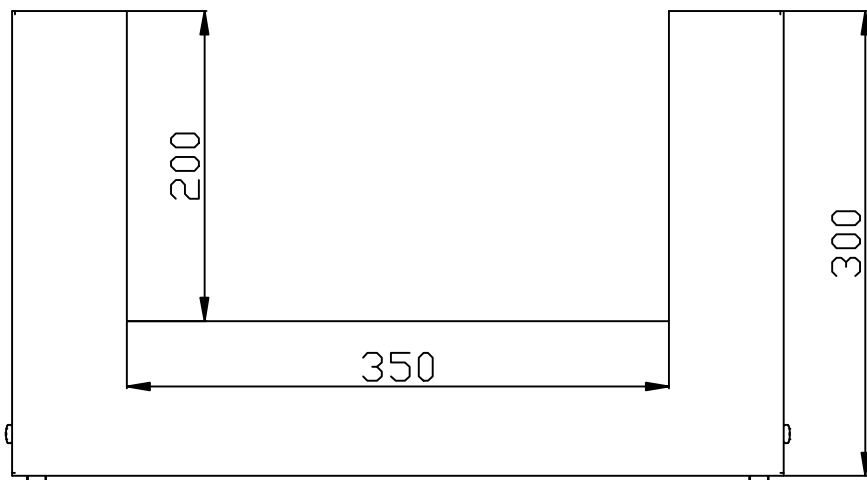
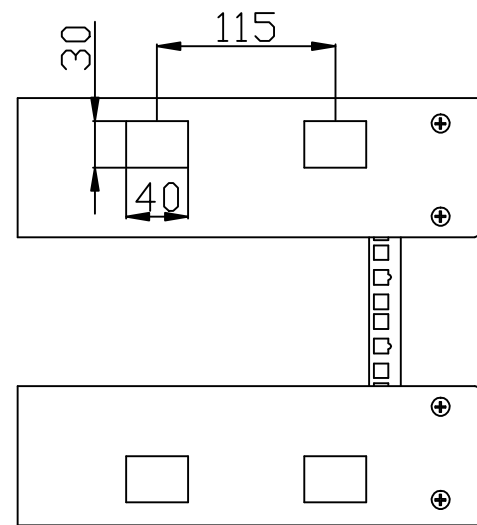
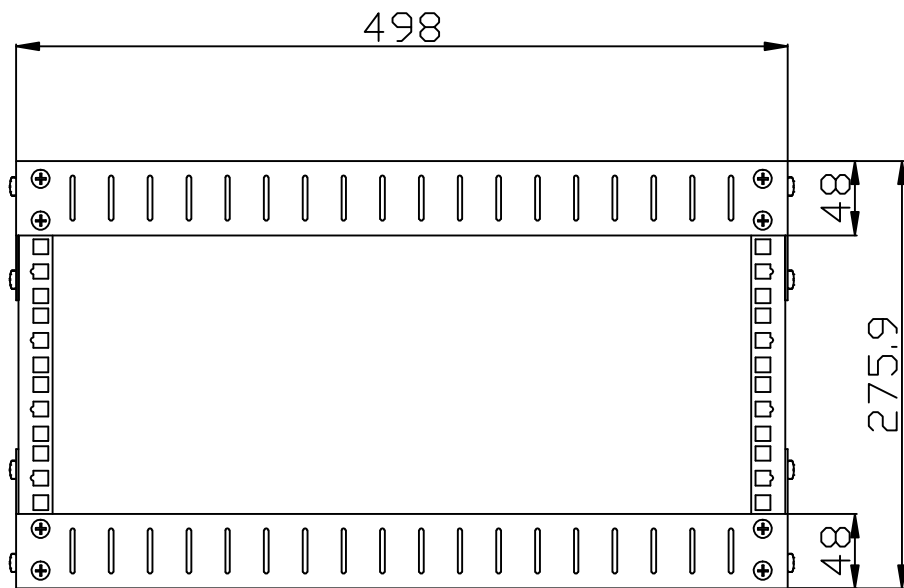

ALL-SWD5304GRAU

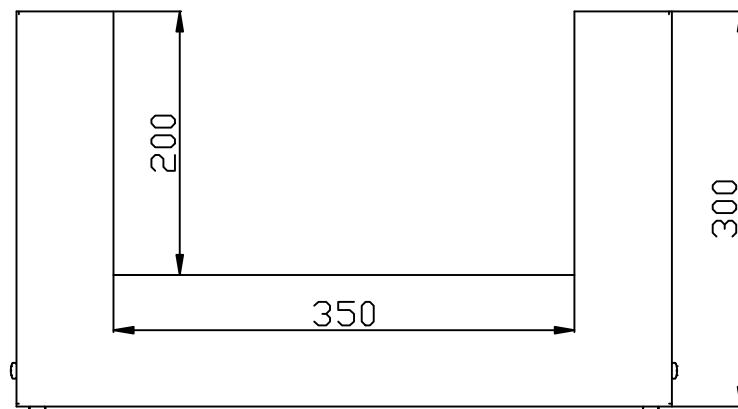
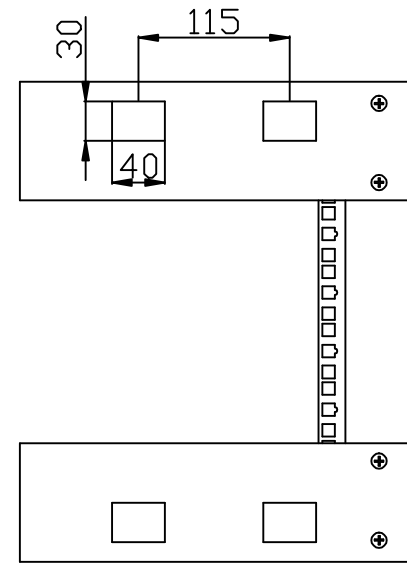
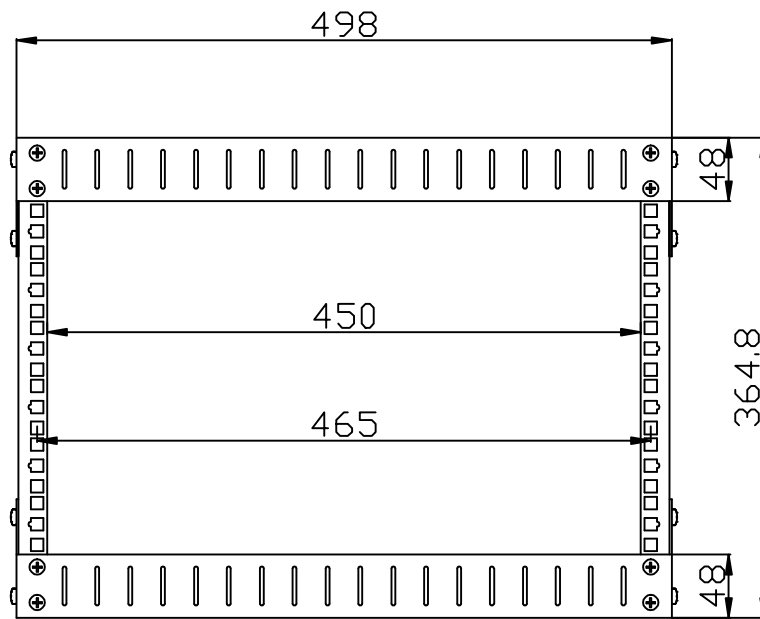

ALL-SWD5306GRAU

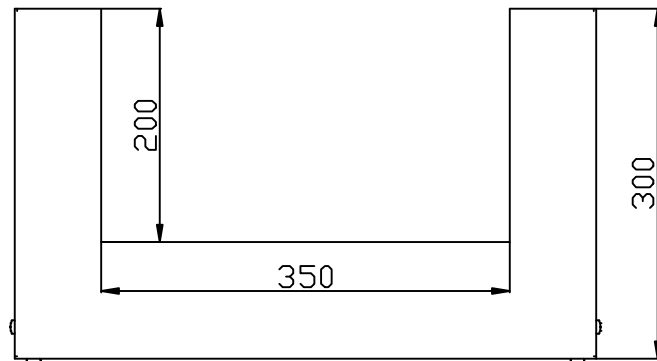
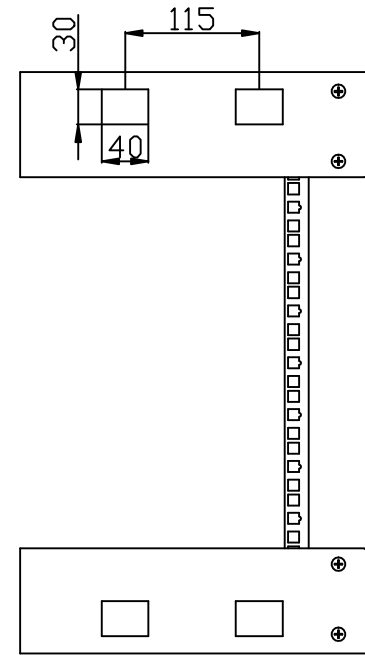
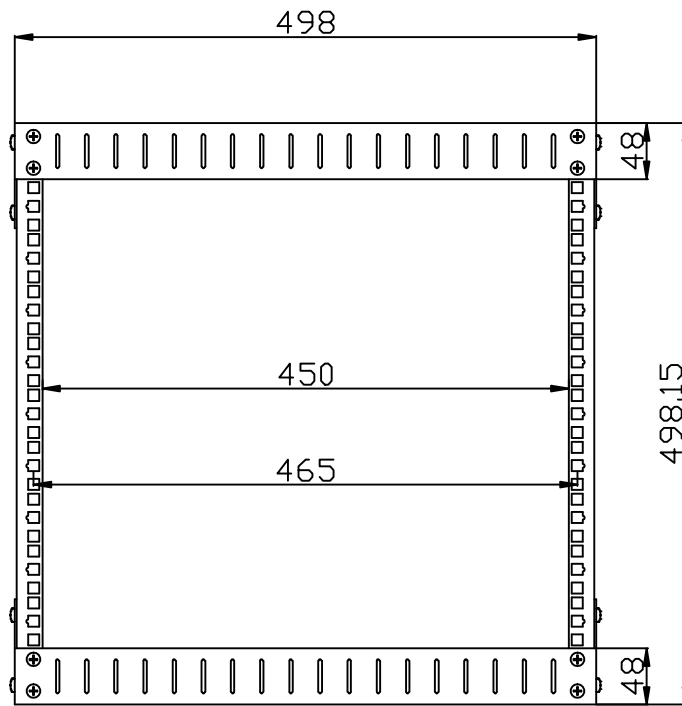

ALL-SWD5309GRAU