

AXIS T8606 Wedge Mount

Wedge mount which positions the AXIS I8116-E Network Intercom either 30 degrees left or right when installing it on a wall. This wedge mount can also be used to mount the intercom on poles.

- > Suitable for wall or pole mount
- > Positions AXIS I8116-E in a 30 degrees angle
- > PVC free and BFR/CFR free



AXIS T8606 Wedge Mount

General

Supported products	AXIS I8116-E Network Intercom, AXIS T18605 Protection Cover
Casing	Aluminum Color: black NCS S 9000-N
Mounting	Wall or pole mounting
Environment	Outdoor/indoor
Dimensions	For the overall product dimensions, see the dimension drawing in this datasheet.
Weight	89 g (0.2 lb)
Box content	Wedge mount, screws, installation guide
System tools	AXIS Site Designer, AXIS Device Manager, product selector, accessory selector, lens calculator Available at axis.com
Warranty	3-year warranty, see axis.com/warranty
Part numbers	Available at axis.com/products/axis-ti8606-wedge-mount#part-numbers

Sustainability

Substance control	PVC free, BFR/CFR free in accordance with JEDEC/ECA Standard JS709 RoHS in accordance with EU RoHS Directive 2011/65/EU and 2015/863, and standard EN IEC 63000:2018 REACH in accordance with (EC) No 1907/2006. For SCIP UUID, see echa.europa.eu
Environmental responsibility	axis.com/environmental-responsibility Axis Communications is a signatory of the UN Global Compact, read more at unglobalcompact.org

Dimension drawing

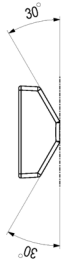
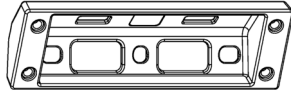

30° Mounting angle to wall.

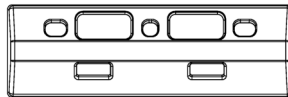
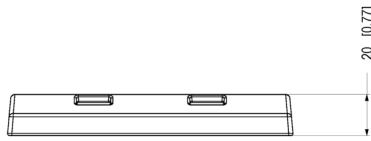
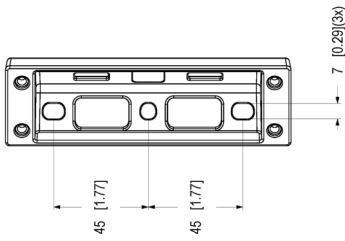
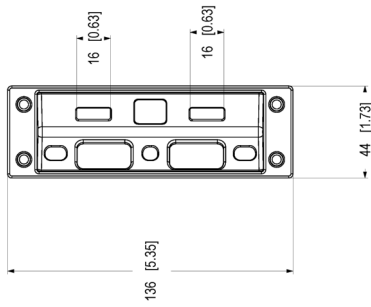

Dimensions in mm [inch]	
201.00.029	M21 L1
1818007	AX 1.101

AXIS T18606 Wedge Mount

